

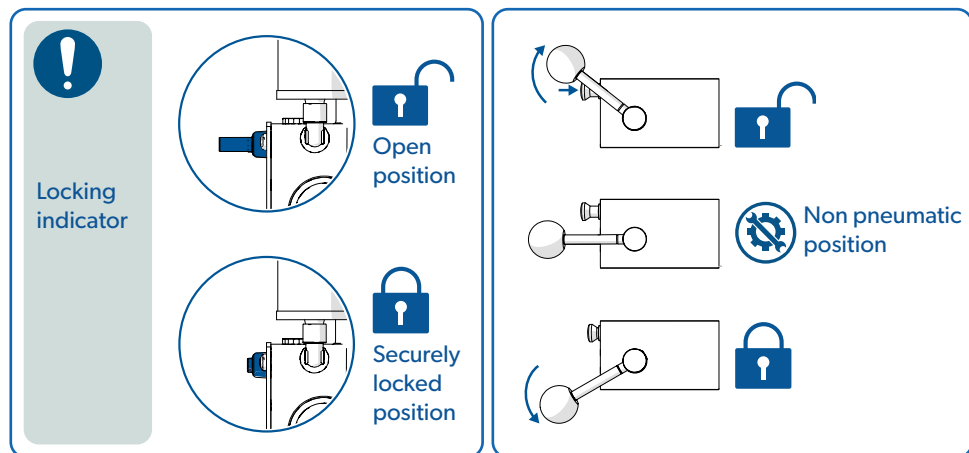

TAV Coupling equipment

Operating and maintenance instructions

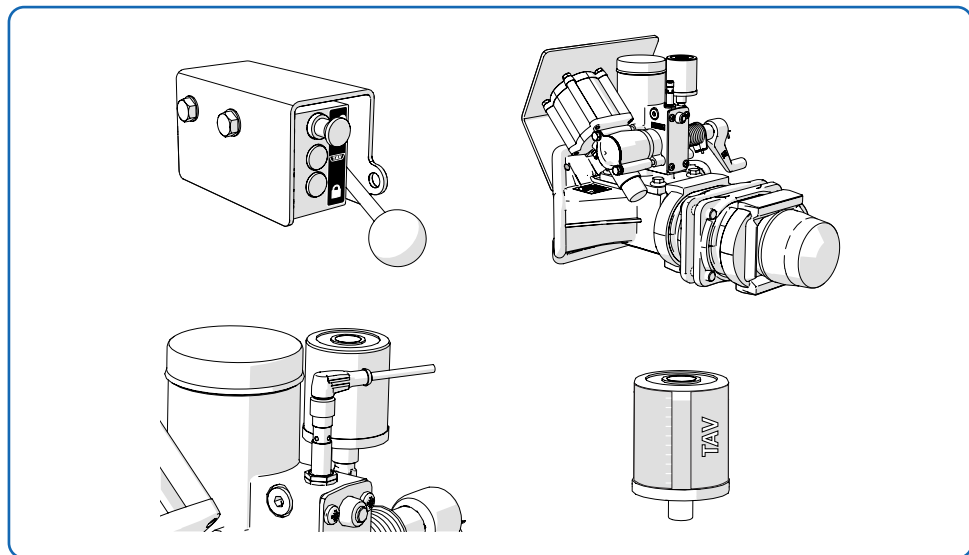



CONNECT

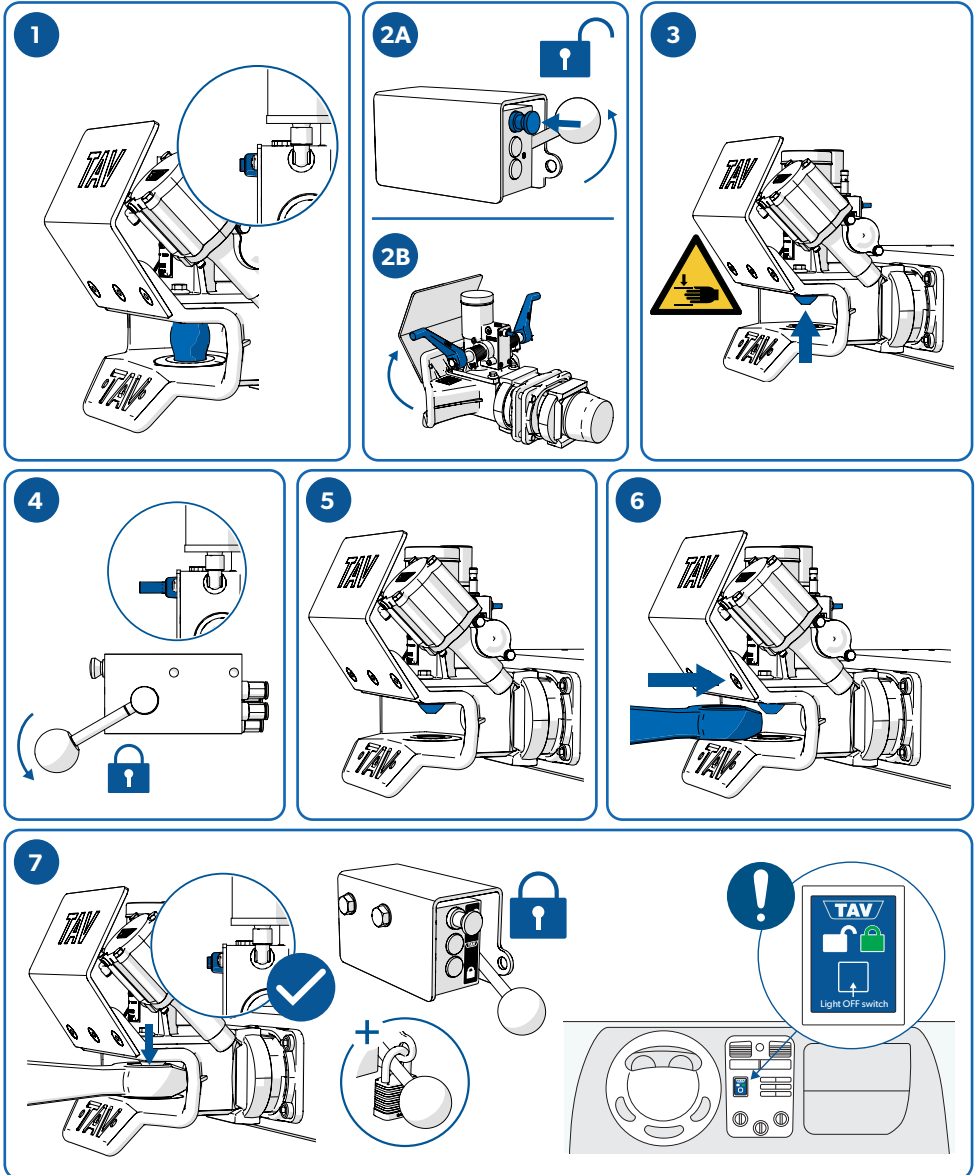



DISCONNECT

1

2A

2B

3

4

5

Firmly tap the crank to release the coupling head.

6



WEEKLY SERVICE

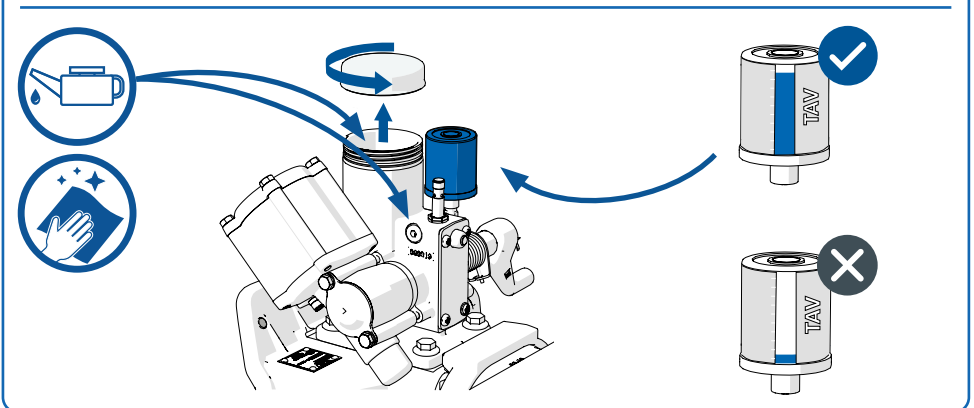
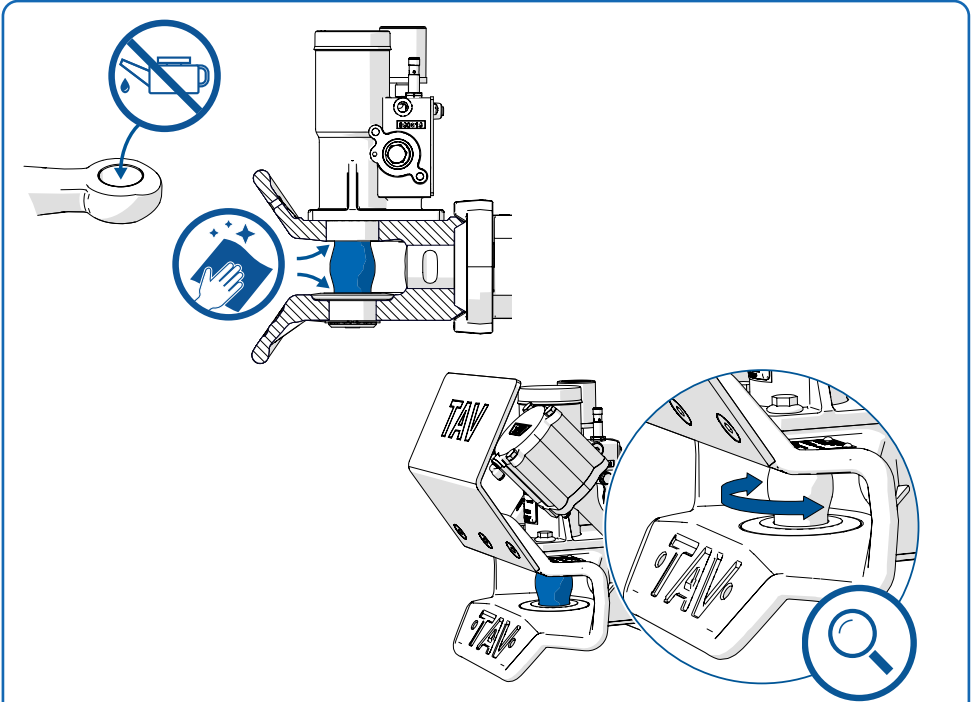
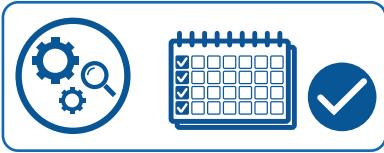



ANNUAL SERVICE



1

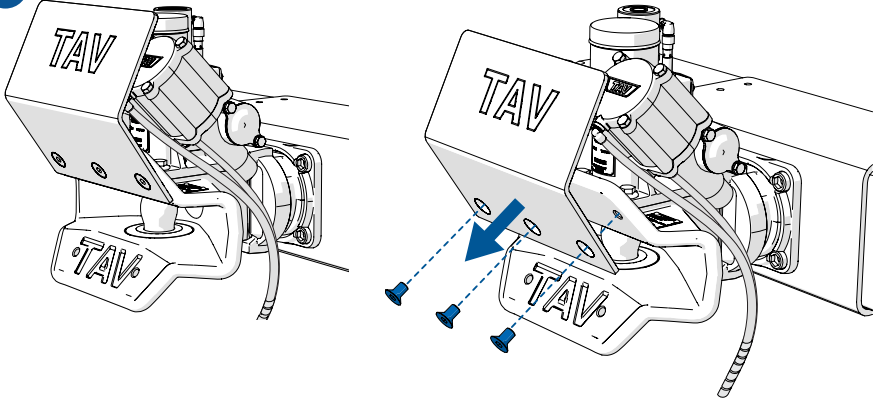

2

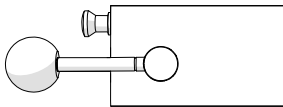

Non pneumatic
mode

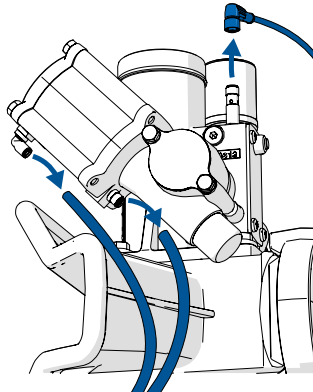

OFF

3

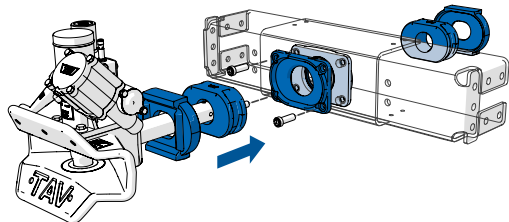
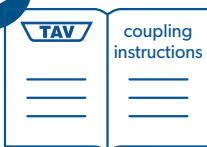
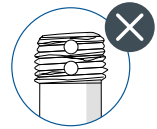
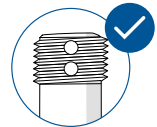
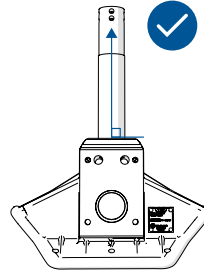
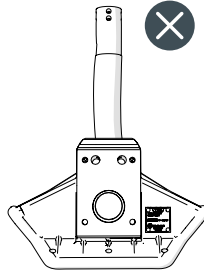
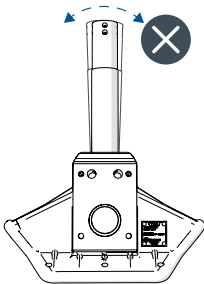
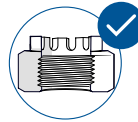
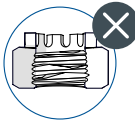
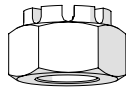
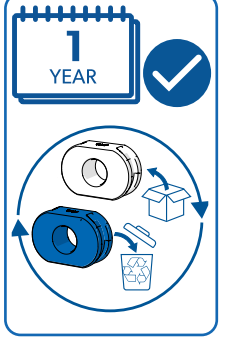
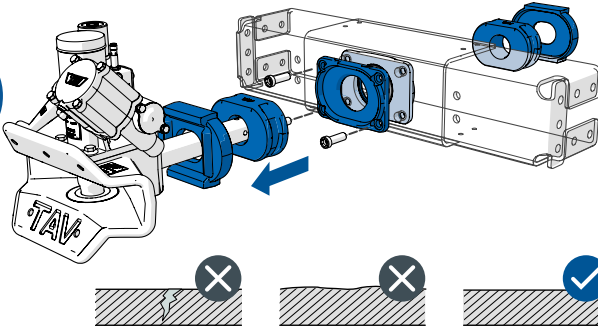

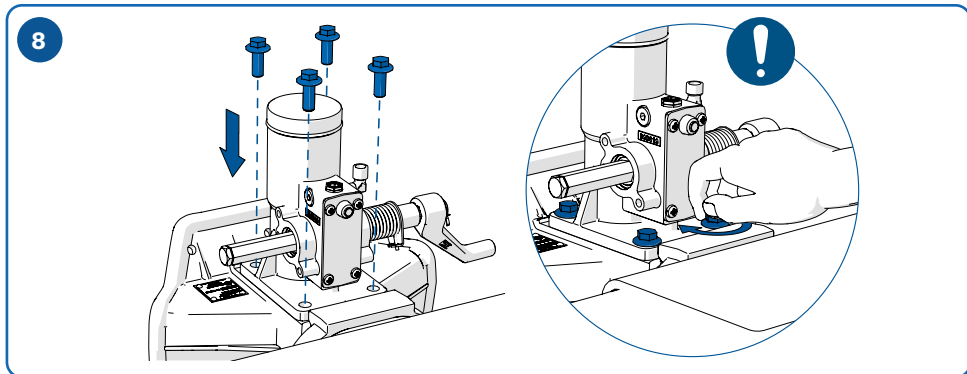
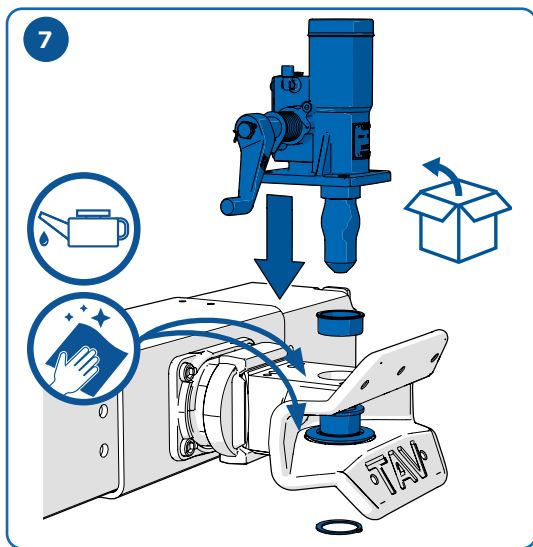
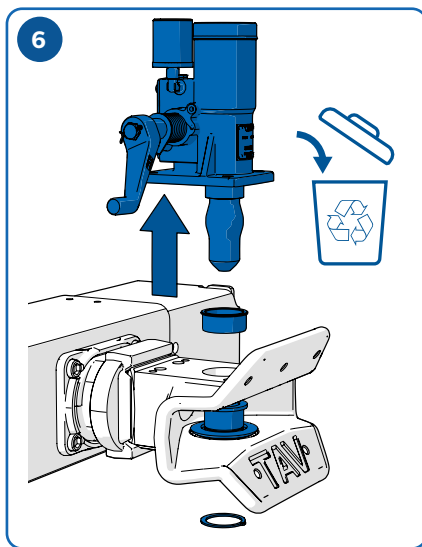
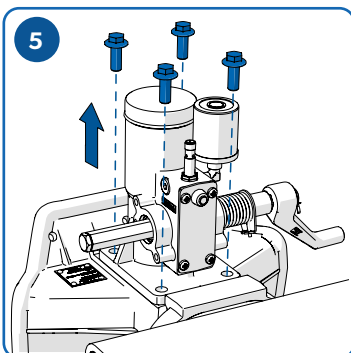
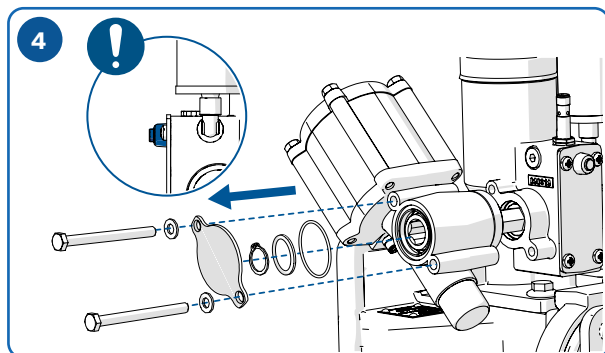

9

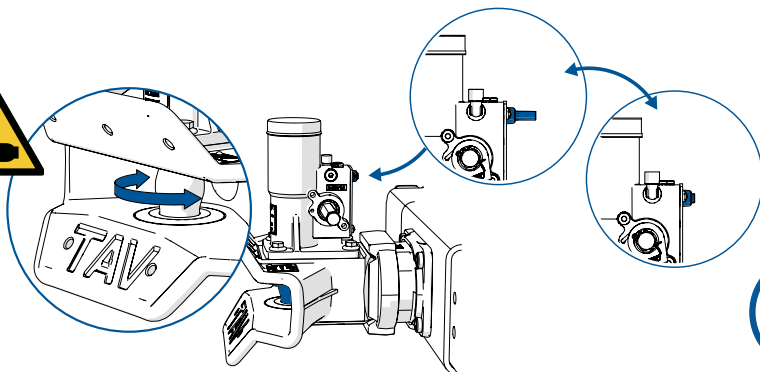

10

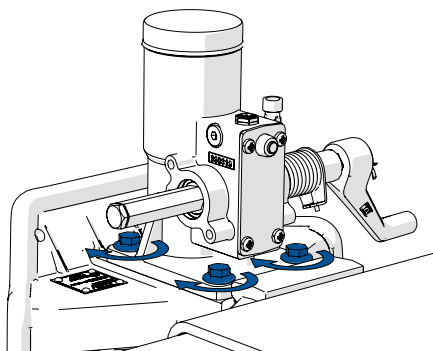

100Nm
Tighten with
torque wrench



11

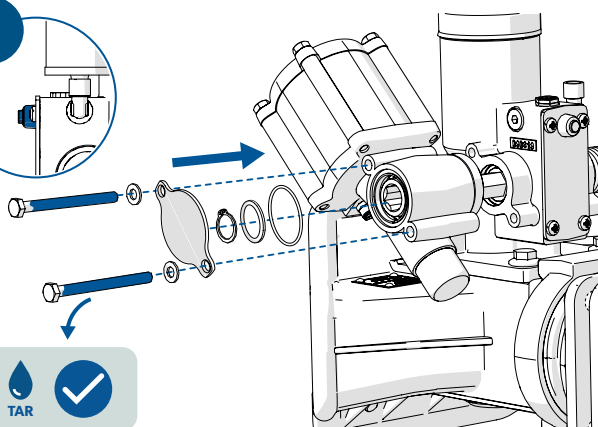
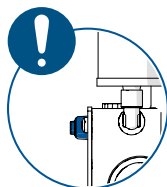

20Nm
Tighten with
torque wrench

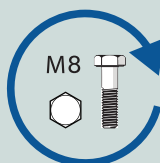

TAR



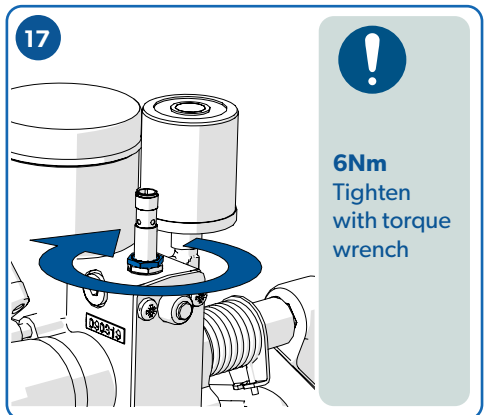
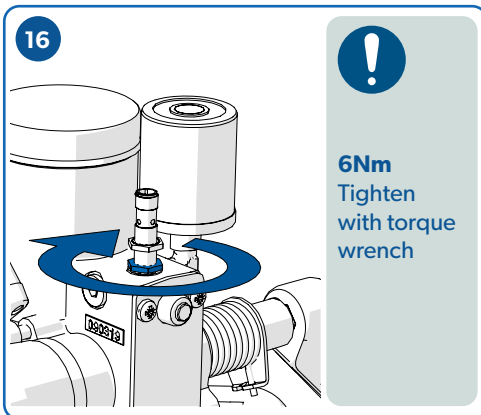
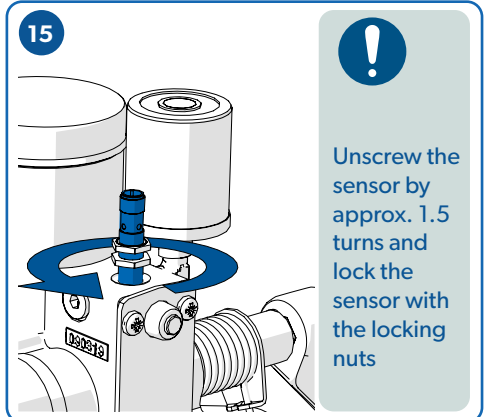
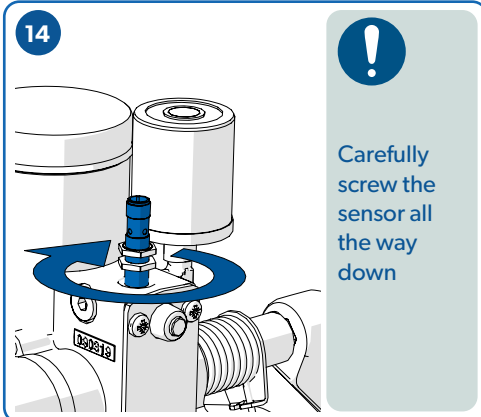
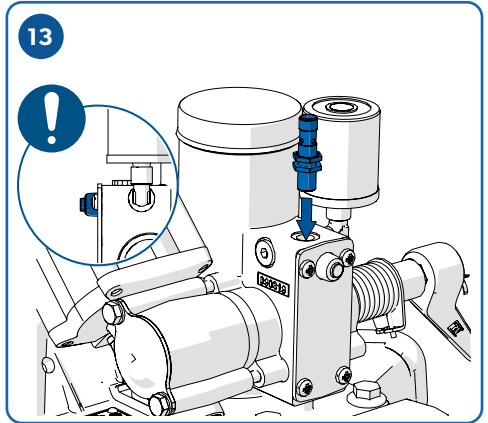
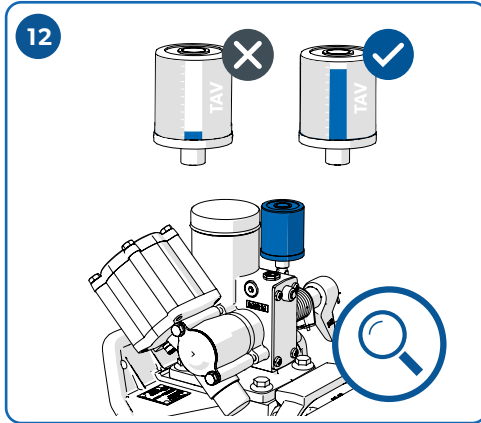

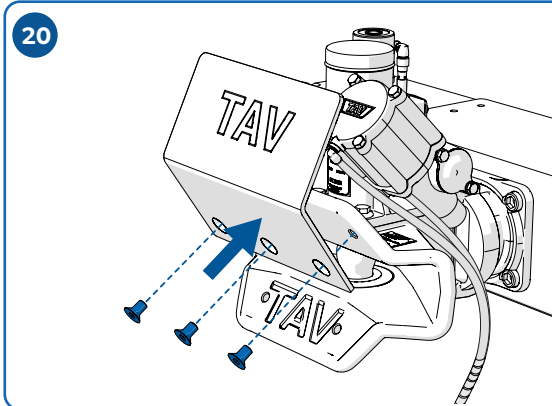
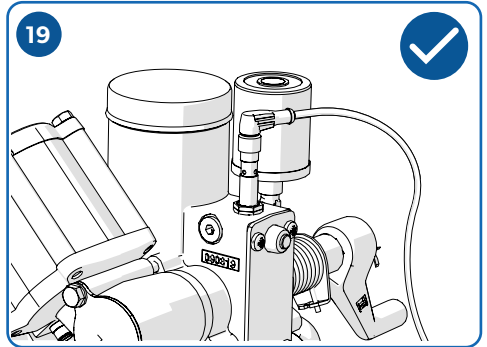
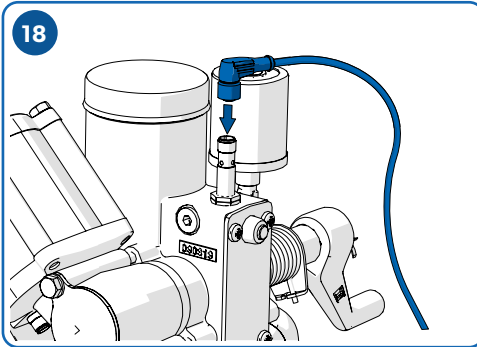

45Nm
Tighten with torque
wrench



Min. 8 BAR
Max 10 BAR

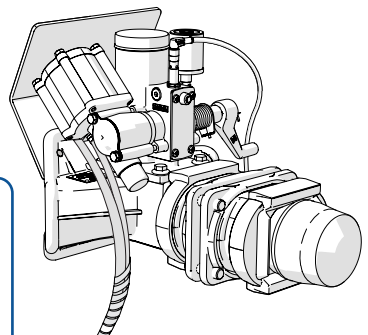
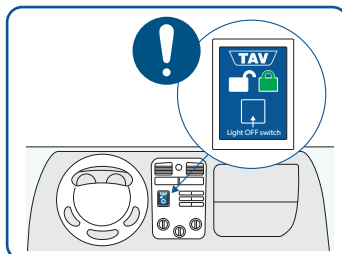
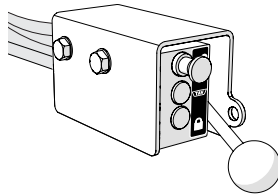



max 5.0mm

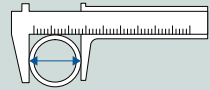
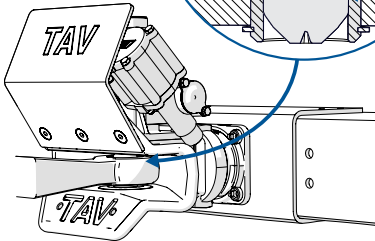
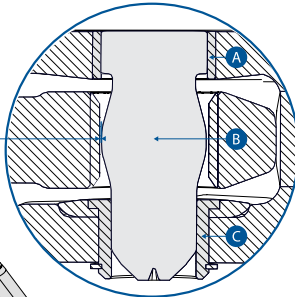

Ø max 51.5mm



Ø max 40.5mm

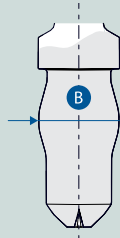
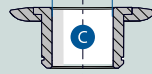

Ø min 47mm

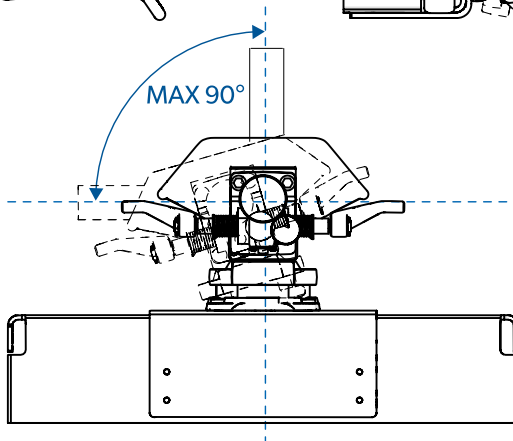
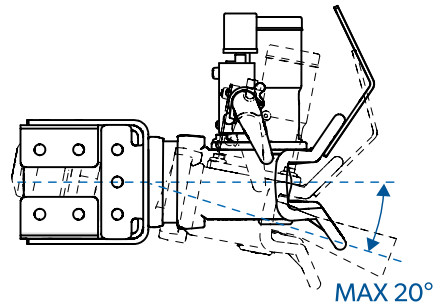
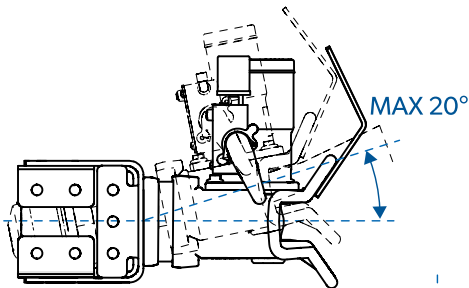



TAV5100

1

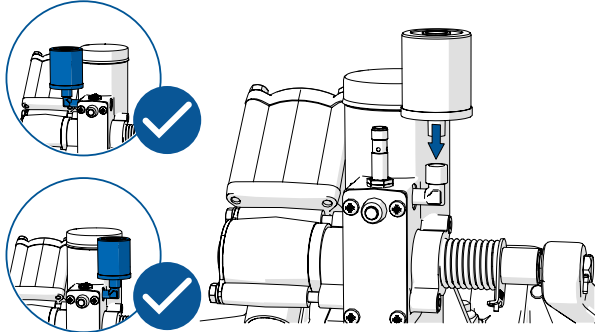

2

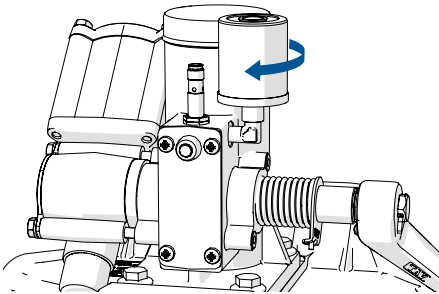

3

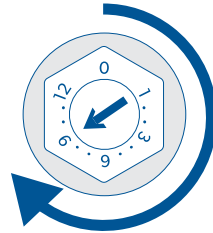

Recommended setting between 6 - 9

4

